

TERRACE FLOOR PLAN

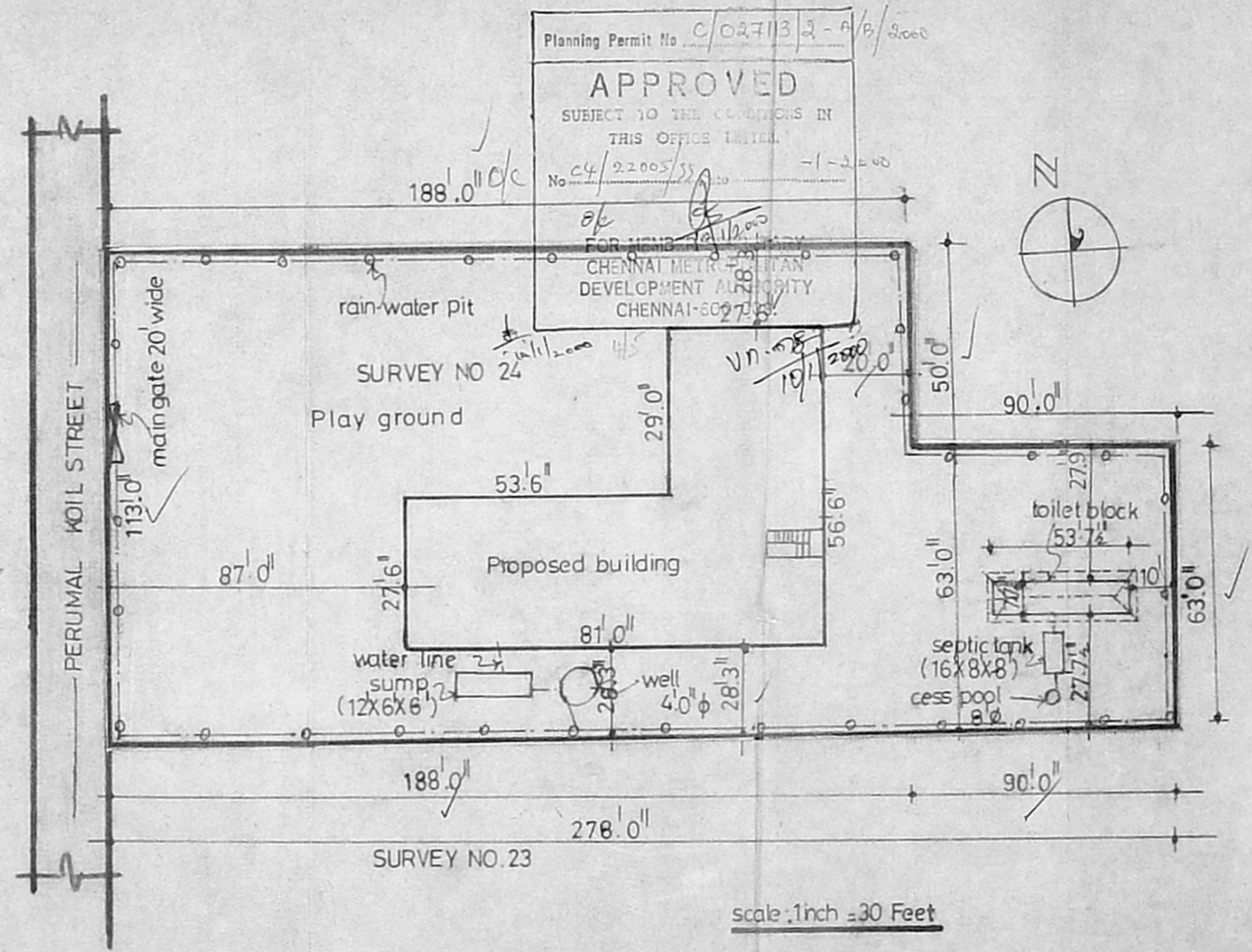

SITE PLAN

scale: 1 inch = 30 Feet

For VIVEKANANDA VIDYALAYA
 (R. RADHAKRISHNAN)
 Hon. Correspondent

APPLICANT

V. Balasubramani
 V. BALASUBRAMANI, B. Arch. A.I.A., M.S.A.,
 ARCHITECT & VALUER
 GOVT. OF INDIA, REGD. VALUER C1407/88-89
 Regd. No. 10712 Council of Architecture
 Class I Licensed Surveyor R.A. No. 8
 CORPORATION OF CHENNAI
 CANARA BANK APPD. VALUER,
 3, Paper Mills Road, First Floor,
 NEAR PERAMBUR CHURCH, CHENNAI-600 011

LICENSED SURVEYOR

87/35
 R.P. dt 13/11/85

CMDA 'C' / PP No. 1	
C. No. C4/22005/85	
Asst.	
Secretary	16/11/85
PART I	
PART II	
A.P.	D.P.

TERRACE PLAN AND SITE PLAN
 FOR THE PROPOSED HIGH SCHOOL
 BUILDING IN SURVEY NO. 24,
 DOOR NO. 87 FOR Smt. SAMJUBEN
 KAPURCHAND PAREKH VIVEKANAND
 VIDHYALAYA, PERUMAL KOILST,
 PERIYA SEKKADU, MADHAVARAM
 MUNICIPALITY, AMBATTUR TALUK,
 THIRUVALLUR DISTRICT.

SCALE: 1 inch = 8 feet, 1 inch = 30 feet

NOTE: All dimensions are in feet and inches

SHEET NO. 2

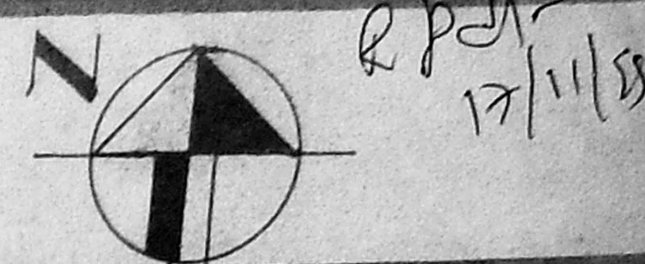

R.P. 17/11/55

SPECIFICATION :

- ALL FOUNDATION AND LEVELLING COURSE FLOOR TO BE 1:4 MIX.
- BRICK WORK IN CM 15 MIX FOR FOUNDATION SUPER STRUCTURE.
- ALL RCC WORKS TO BE 1:2:4 MIX.
- PLASTERING WALLS IN CM 15 MIX. CEILING PLASTER AND FLOOR FINISH IN CM 1:3 MIX.
- WEATHERING COURSE WITH A LAYER OF FLAT TILES IN CM 1:3 MIX.
- COUNTRY WOOD DOORS AND WINDOWS WITH TWO COATS ENAMEL PAINT OVER ONE COAT PRIMER.
- THREE COATS OF COLOUR WASHING FOR INNER AND OUTER WALLS.

SCHEDULE OF JOINERIES

TYPE	DESCRIPTION	SIZE
D	c.w panelled door	3'6" x 7'0"
D1	c.w panelled door	2'6" x 7'0"
W	c.w panelled window	6'0" x 4'0"
V	c.w louvered ventilator	2'0" x 1'6"
J	Jalli	6'0" x 6'0"
BS	Book shelf	4'0" x 7'0"
33	Black board	10'0" x 4'0"

LEGEND

- Proposed
- Boundary
- Road

AREA STATEMENT

SITE EXTENT : 26914 sft or 2500 sqm
 Ground floor plan : 3025 sft or 281.13 sqm
 First floor plan : 3025 sft or 281.13 sqm
 Second floor plan : 3025 sft or 281.13 sqm
 TOTAL 9075 sft or 843.39 sqm
 Non.f.s.i area : 247.25 sft or 22.98 sqm
 Achieved plot coverage : 11%
 Achieved f.s.i : 0.34

PLAN SHOWING PROPOSED HIGH SCHOOL BUILDING IN SURVEY NO.24 FOR Smt. SAMJUBEN KAPURCHAND PAREKH VIVEKANAND VIDHYALAYA PERUMAL KOIL ST, PERIYA SEKKADU, MADHAVARAM MUNICIPALITY, AMBATTUR TALUK, THIRUVALLUR DISTRICT.

STUDENTS DETAILS

BOYS : 280 Nos | GIRLS : 220 Nos

SCALE : 1 inch = 8 Feet (1:700)

DATE :

For VIVEKANANDA VIDYALAYA
 (R. RADHAKRISHNAN)
 Mon. Correspondent
 APPLICANT

TOTAL NUMBER OF SHEETS : 2 SHEET NO. : 1

V. BALASUBRAMANI, B.A.M., A.L.A., S.E.A., ARCHITECT & VALUER
 JOINT. OF INDIA, REGD. VALUER, CH/107/100-99
 Regd. No. 10112 Council of Architecture
 Class I Licensed Surveyor R.A. No. 2 CORPORATION OF CHENNAI
 CANARA BANK BLDG., VALUER,
 3, PAPER MILLS ROAD, FIRST FLOOR,
 NEAR PERAMBUR CHURCH, CHENNAI-600 011
 LICENSED SURVEYOR

CMDA 'C' / PP No. 1
 C. No. 24/2005/SS
 Assd. 10/11/2005
 PART I
 PART II
 A.P. D.P.

R.O.H 12/11/55

Planning Permit No. C/627113/2 - B/B/2000
APPROVED
 SUBJECT TO THE CONDITIONS IN THIS OFFICE LETTER.
 24/2005/SS - 1 - 2000
 No. de
 FOR MEMBER PERMANENT CHENNAI METR. POLITAN DEVELOPMENT AUTHORITY CHENNAI-600 002.

5/5
 10/11/2000

